



# Parts and Accessories. Installation Instructions.

## TV reception retrofit BMW X3 (E83)

**These installation instructions are only valid for cars with SA 609 (navigation system).**

**Retrofit kit No.**      65 50 0 306 968  
                                 65 50 0 397 353

### Installation time

The installation time is 2,0 hours, but this may vary depending on the condition of the car and the equipment in it.

### Important information

These installation instructions are primarily designed for use within the BMW dealership organisation and by authorised BMW service companies.

In any event the target group for these installation instructions is specialist personnel trained on BMW cars with the appropriate specialist knowledge.

All work must be completed using the latest BMW repair manuals, circuit diagrams, servicing manuals and work instructions in a rational order using the prescribed tools (special tools) and observing current health and safety regulations.

Ensure that the cables/lines are not kinked or damaged as you install them in the car. The costs incurred as a result of this will not be reimbursed by BMW AG.

Additional cables/lines that you install must be secured with cable ties.

All the figures show LHD cars, proceed in exactly the same way on RHD cars.

Some of the installation of the aerial is shown only on the left-hand side of the car, proceed in the same way on the right-hand side of the car.

### Pictograms



denotes instructions that draw your attention to dangers.



denotes instructions that draw your attention to special features.

◀ denotes the end of the instruction or other text.

See the EBA CD or Aftersales Portal for explanations of the pictograms.

Do not archive the hard copy of these installation instructions since daily updates are made by Aftersales Portal.

Subject to technical modifications.

**Information on operation**

The TV function is only active when the car is at a standstill.

**Special tools required**

Releasing bar (65 5 400)

## Contents

### Section

1. Parts list .....	4
2. Preparations.....	5
3. Connection diagram.....	6
4. Installation and cabling diagram .....	7
5. To install and connect the bumper aerial .....	8
6. To install and connect the video module .....	10
7. Concluding work and coding .....	11
8. Circuit diagram .....	12

# 1. Parts list

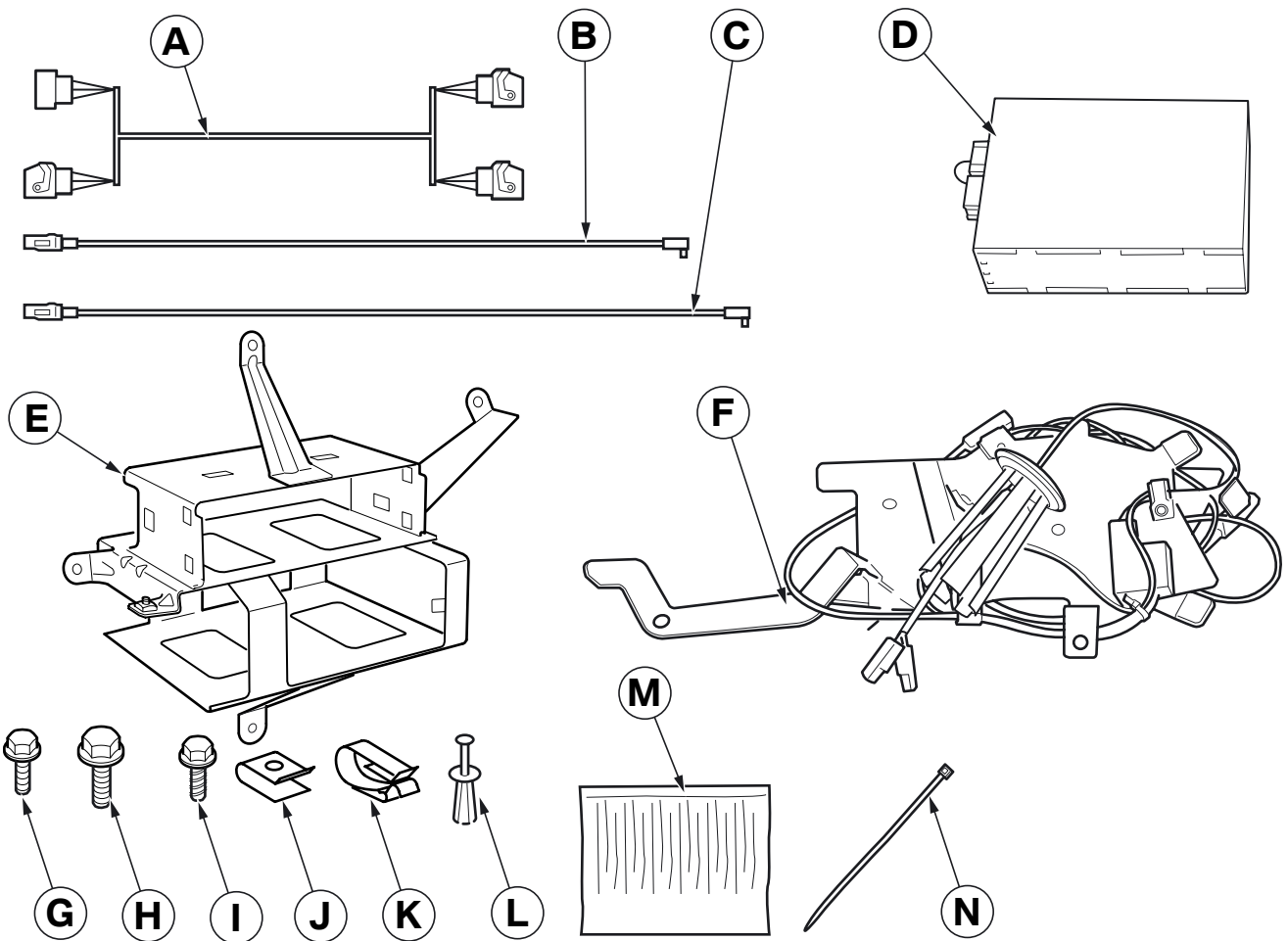

083 0214 Z

## Legend

- A Adapter cable
- B Aerial cable TV 1
- C Aerial cable TV 2
- D Video module
- E Video module bracket
- F Bumper aerial
- G Hexagonal screw with washer M5 x 12 mm
- H Hexagonal screw with washer M6 x 15 mm
- I Hexagonal self-tapping screw 4.8 x 9 mm (2x)
- J Speed nut M6
- K Cable holder (6x)
- L Expanding rivet 6 mm (6x)
- M Protective strip
- N Cable tie (5x)

## 2. Preparations

	TIS No.
Conduct a brief test	---
Disconnect the negative pole of the battery	12 00...
<b>The following components must be removed first of all</b>	
Rear bumper	---
Boot floor	---
Boot trim on the left	---
Navigation computer	---
Navigation computer holder (no longer required)	---

### 3. Connection diagram

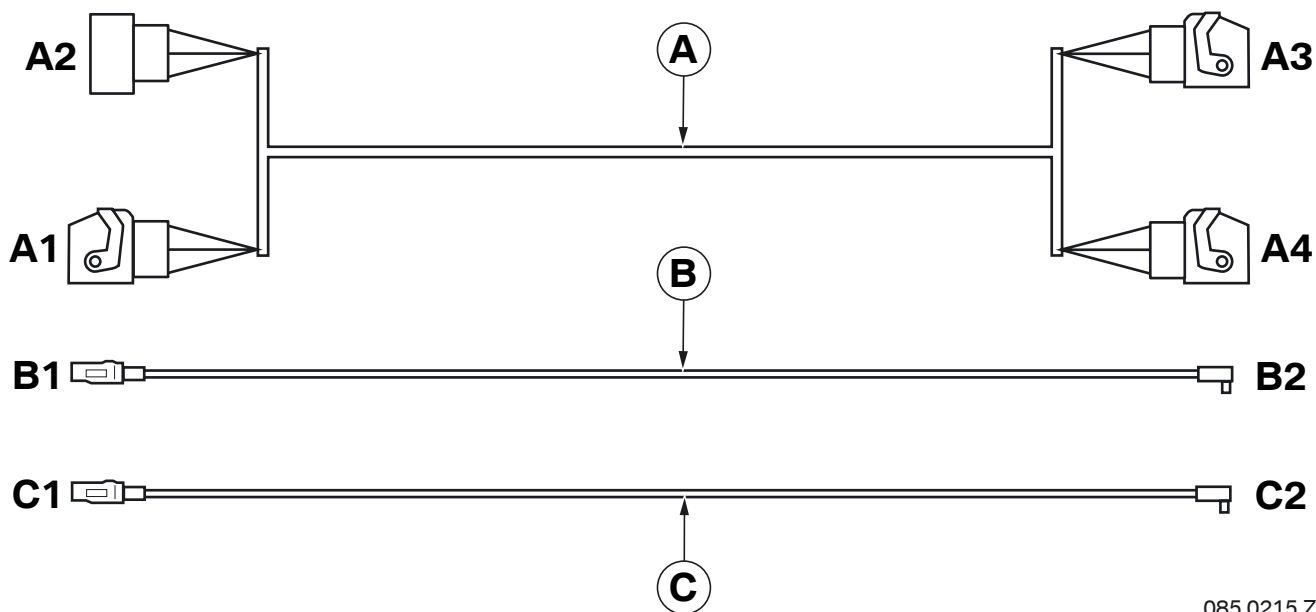

085 0215 Z

Branch	Description	Signal	Cable colour / Cross-section	Connection location in the car	Abbreviation / Slot
A	Adapter cable	---	---	---	---
A1	BL 18-pin socket casing	---	---	To navigation computer <b>A112</b>	X1313
A2	18-pin BL plug casing	---	---	To standard wiring harness plug, BL 18-pin socket casing	X1313
A3	BL 18-pin socket casing	---	---	To video module <b>A197</b>	X18804
A4	WS 18-pin socket casing	---	---	To video module <b>A197</b>	X18806
B	Aerial cable TV 1	---	---	---	---
B1	Plug casing GN	---	---	To socket casing on bumper aerial	---
B2	Angle aerial plug	---	---	To video module <b>A197</b>	X13348
C	Aerial cable TV 2	---	---	---	---
C1	Plug casing WS	---	---	To socket casing on bumper aerial	---
C2	Angle aerial plug	---	---	To video module <b>A197</b>	X13349

## 4. Installation and cabling diagram

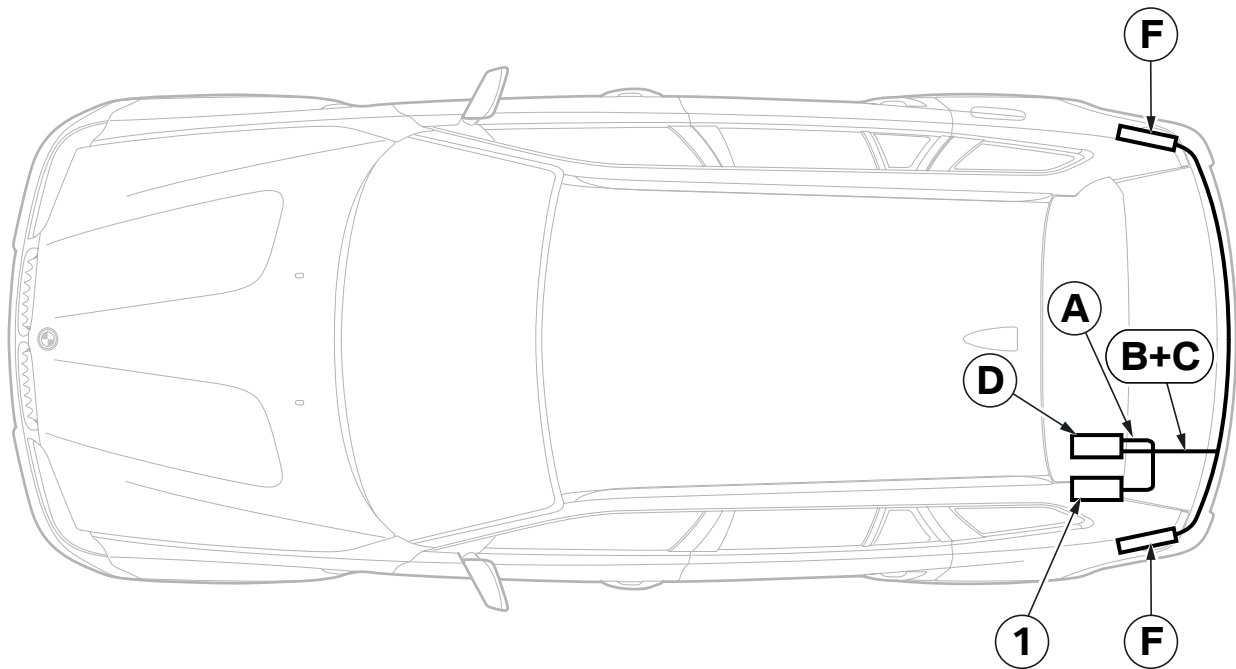

083 0216 Z

### Legend

- A Adapter cable
- B Aerial cable TV 1
- C Aerial cable TV 2
- D Video module **A197**
- F Bumper aerial
  
- 1 Navigation computer

## 5. To install and connect the bumper aerial

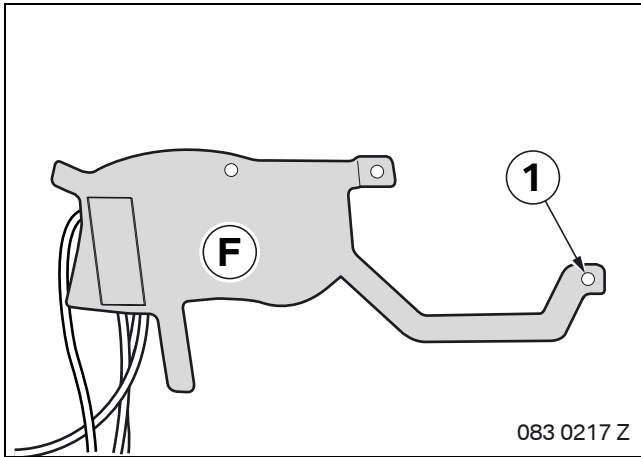

Drill a hole through the bumper aerial **F** with a 6 mm twist drill bit at point (1).

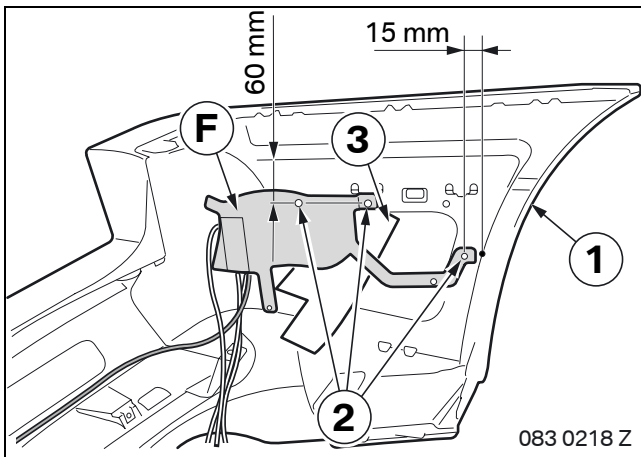

**!** Whilst you drill the hole place a metal plate (3) between the bumper (1) so as not to damage the exterior skin of the bumper. ◀

Insert the bumper aerial **F** in the bumper (1) using the dimensions shown.

Mark the holes (2) and drill through the internal skin of the bumper (1) using a 6 mm twist drill bit.

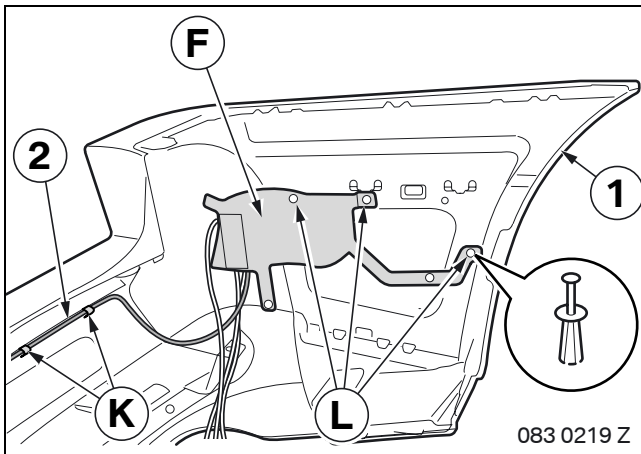

Secure the bumper aerial **F** to the bumper (1) using expanding rivets **L**.

Install the bumper aerial **F** on the right-hand side using the same procedure.

Secure the connection cable (2) to the bumper (1) with a cable holder **K**.

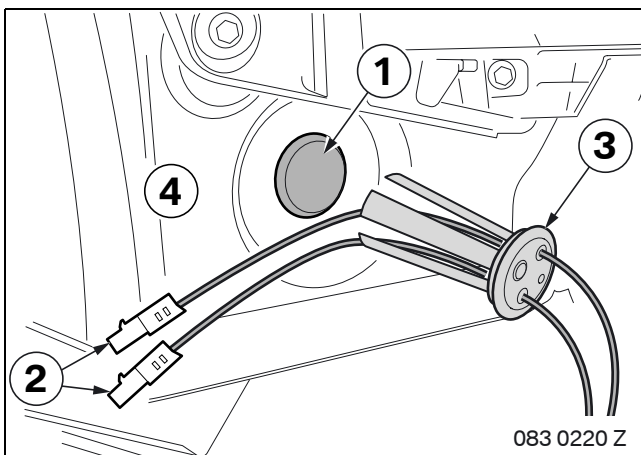

### Cars without an exhaust valve only

Remove the sealing stopper (1).

Route the aerial cable (2) into the interior of the car.

Insert the rubber grommet (3) into the closing panel (4).

5. To install and connect the bumper aerial

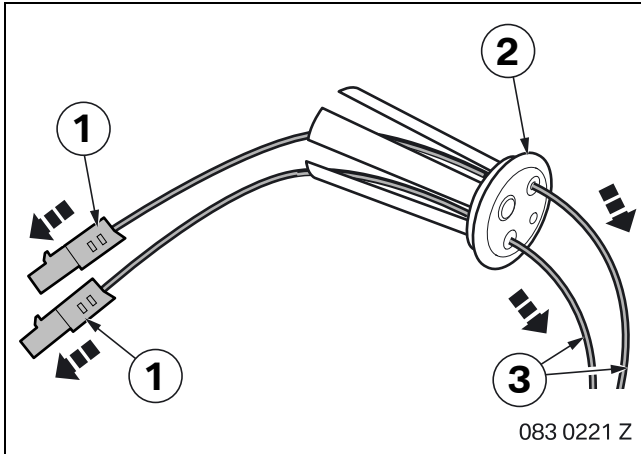

**Cars with an exhaust valve only**

Remove the socket casing (1) from the aerial cables (3).

Pull the aerial cables (3) out of the rubber grommets (2).

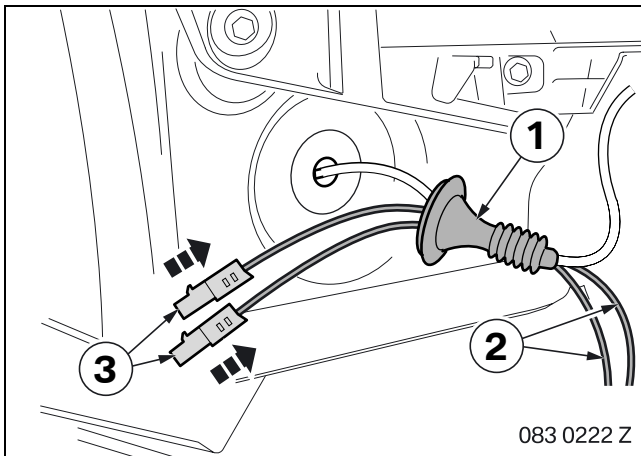

Remove the rubber grommet (1) from the rear closing panel and route the aerial cables (2) through the rubber grommet (1) into the interior of the car.

Connect the socket casing (3) to the aerial cables (2).

Insert the rubber grommet (1) into the rear closing panel.

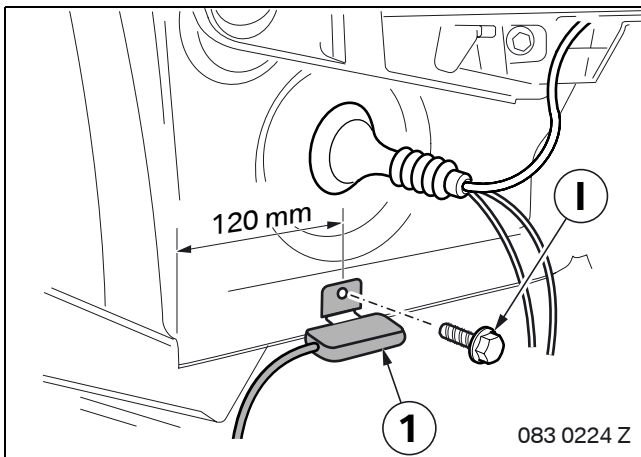

 Deburr the holes and treat them with anti-corrosion coating. ◀

Mark the dimension and drill a hole through the rear closing panel with a 3 mm twist drill bit.

Secure the aerial capacity (1) with a hexagonal screw **I**.

Install the aerial capacity on the right-hand side of the car using the same procedure.

Secure the rear bumper.

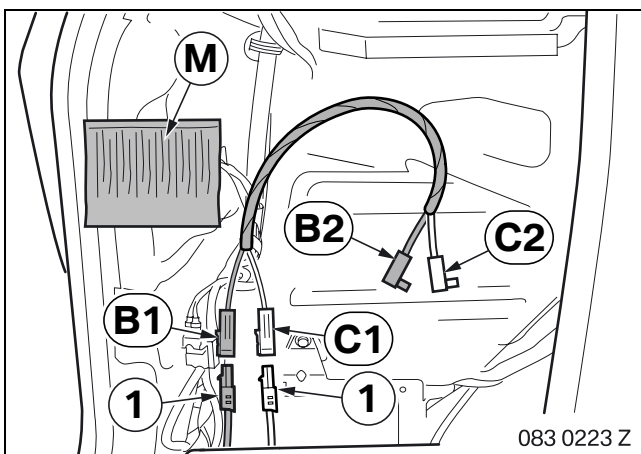

Connect branches **B1** and **C1** to the plugs (1) on the bumper aerial.

Route the aerial plugs **B2** and **C2** to the installation site of the video module **D**.

Wrap the plug connectors on the aerial cables in protective strips **M**.

## 6. To install and connect the video module

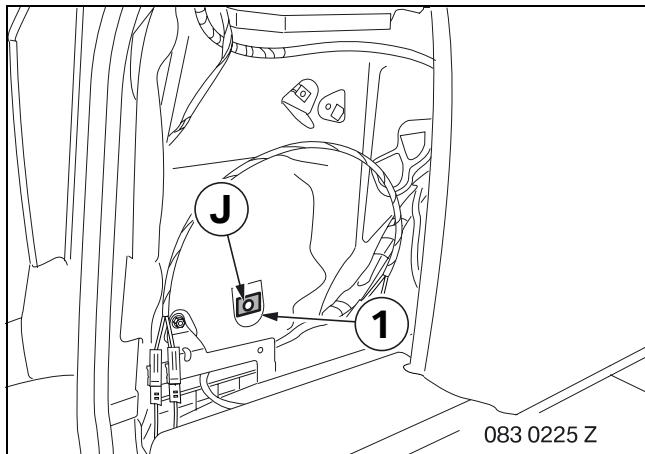

Place a speed nut **J** in the opening (1).

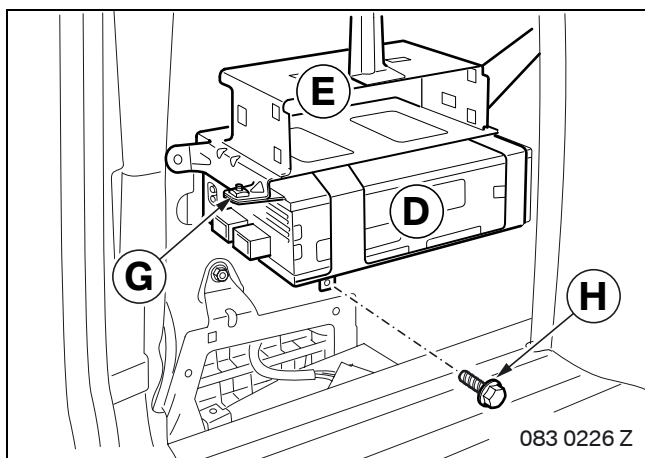

Push the video module **D** into the video module holder **E** and secure it with a hexagonal screw **G**.

Secure the video module holder **E** with the existing screws and also with an additional hexagonal screw **H**.

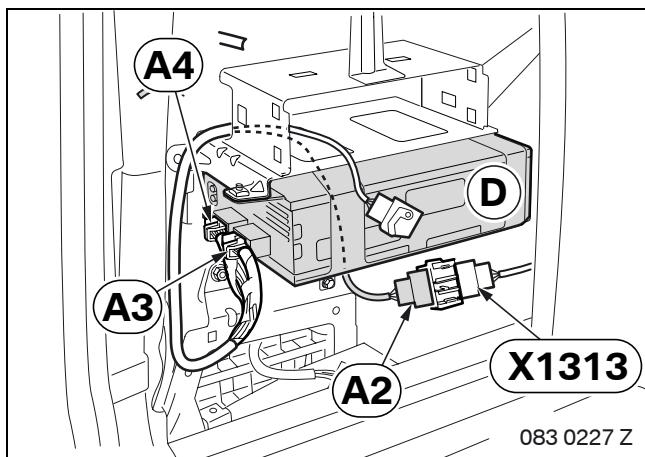

Connect branches **A3** and **A4** to the same coloured cables on the video module **D**.

Connect branch **A2** to plug **X1313** on the standard wiring harness.

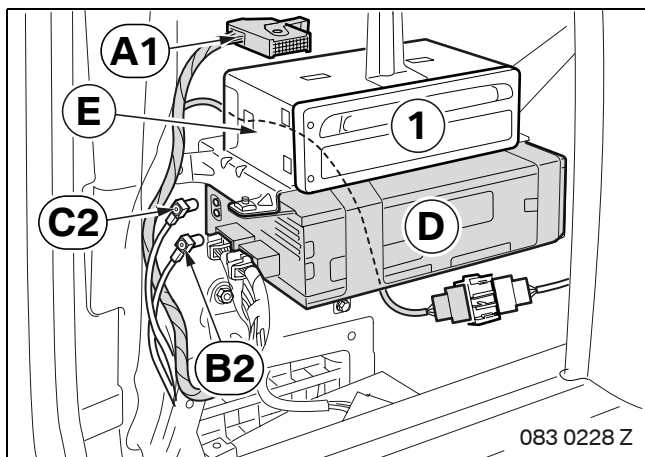

Connect branch **A1** to the navigation computer (1).

Connect branches **B2** and **C2** to the video module **D**.

Insert the navigation computer (1) into the video module holder **E**.

## 7. Concluding work and coding

This retrofit system requires coding.

- Connect the battery
- Code the retrofit using DISPlus, MoDiC III or GT-1 via path **Retrofit**
- Conduct a brief test
- Conduct a function test
- Re-assemble the car

# 8. Circuit diagram

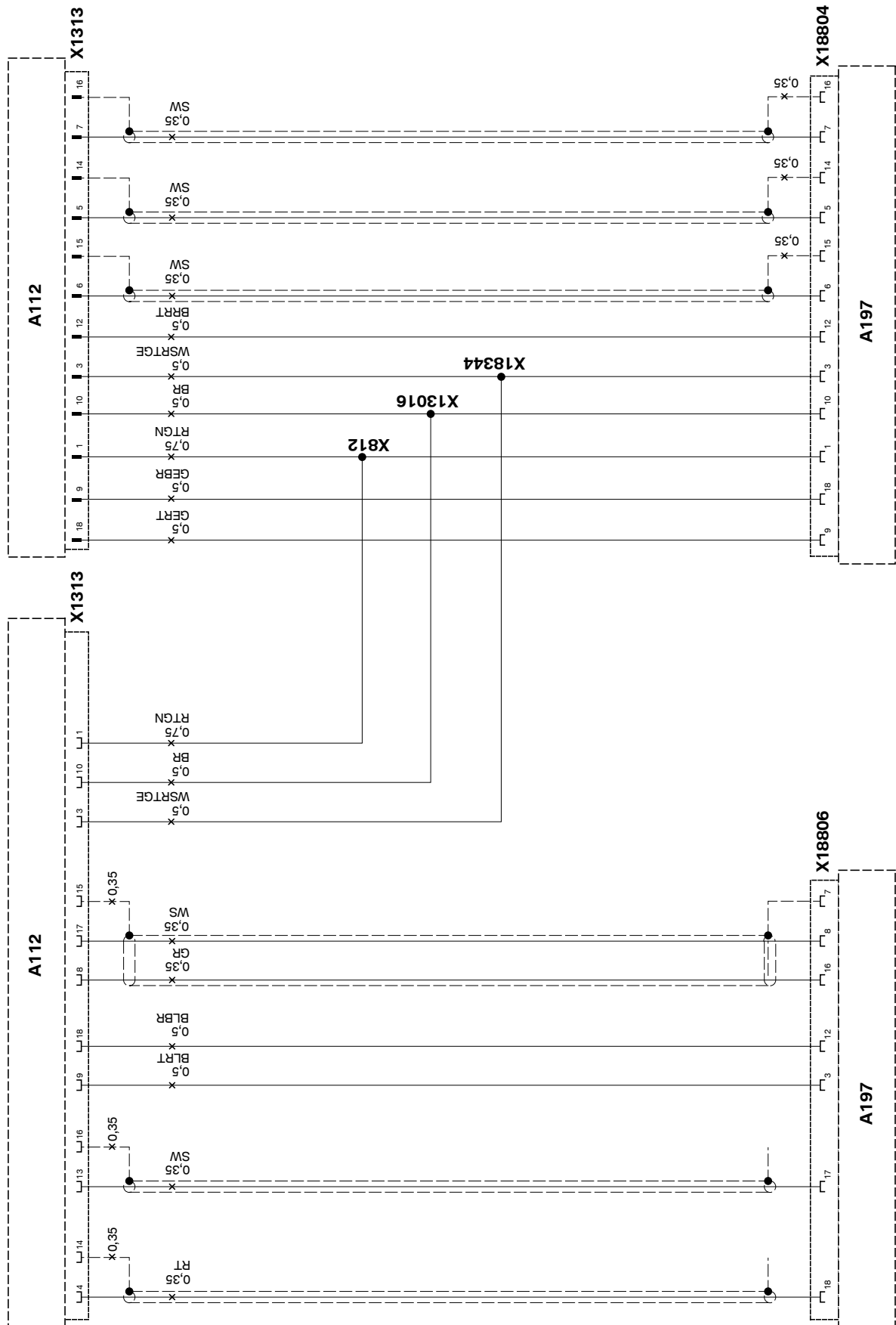

085 0153 Z

## 8. Circuit diagram

### Legend

**A112** Navigation computer

**A197** Video module

**X812** Terminal 30 connector

**X1313** BL 18-pin plug

**X13016** Earth connector

**X18344** I bus connector

**X18804** BL 18-pin plug

**X18806** WS 18-pin plug

### Cable colours

BR Brown

GE Yellow

GN Green

GR Grey

RT Red

SW Black

VI Violet

WS White